

MOBILE SURVEILLANCE

2CH H.264 DVR

2CH HD DVR / Camera



HD 720P DVR

HD 720P Camera*2

Multi-functional OBD display

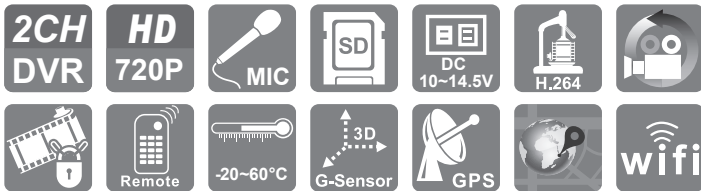

H12AE31A01

Product appearance

■ DVR

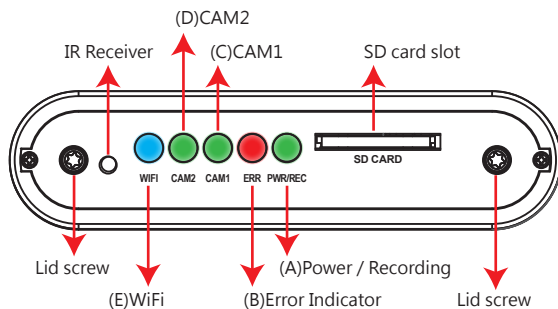

■ Multi-functional OBD display

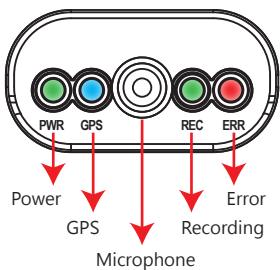

■ Lights indicate:

- (A) PWR (Green) : power indication.
- (B) GPS (Blue) : Flashing mean GPS 3D positioning searching. Consistent blue light on means 3D positioned successfully.
- (C) Microphone : Audio input.
- (D) REC (Green) : Flashing means continuous recording.
- (E) ERR (Red) : Error diagnosis, please check camera signal, OBD display, SD storage ...status.

Cable Installation

• Cables



- (1) Power connector
- (2) Multi-functional OBD display connector
- (3) WiFi antenna
- (4) Video out
- (5) Camera 1 connector
- (6) Camera 2 connector

• Power cable



- (a) Power connection: reception
- (b) Alarm recording (Grey cable): connect to +12V power to do event recording by alarm triggered. Can be used together with switch.
- (c) Power cable (Red): connect to power positive connector.
- (d) ACC activation cable (Brown): connect to motorcycle power switch (+).
- (e) Ground (Black): connect to power supply (-).

Packaging

Please review the package first. The packaging material can resist impact during delivery. Please remove the PE bag to make sure no damage on the housing. Finally make sure the screws are not loose.

■ Motorcycle Type

1. Power cable
2. Multi-functional OBD display (built with GPS and microphone)
3. USB WiFi
4. Car camera (AVM-1225A) x 2pcs
5. 2.5M camera cable
6. 5M camera cable
7. IR Remote Control

■ Vehicle Type

1. Power cable
2. Multi-functional OBD display (built with GPS and microphone)
3. USB WiFi
4. Car camera (AVM-1225A) x 2pcs
5. 5M camera cable x 2pcs
6. IR Remote Control

! Safety Precautions

• Installation Precautions

1. Make sure power connections clear enough to you before installation.
2. System installation is required professional installers and ventilation space.
3. Please use recommended and genuine storage device.
4. Please contact local dealers in case of service requirement.

• In Use Precautions

1. Please keep the inner components off any solid or liquid.
2. Please do not disassemble the equipment for warranty issue. Please contact local dealers or the manufacturer for prompt service.
3. Please remove the battery if remote control keeps idle for quite a long while.
4. The equipment best connects with ground wire in case of outdoor cameras connection or alarm I/O connection. This is to keep the DVR away from static electricity damage.

• Surrounding

1. Please have the DVR under recommended temperature away from the sun and heating source.
2. Please keep this equipment away from humid surrounding.
3. Please keep this equipment away from smoke and dust.
4. Please do not drop the equipment.
5. Please keep this equipment in ventilation space.
6. Please supply rated voltage and Amp. To the equipment.
7. Please keep flammable objects away from the equipment.

Recording

■ System initialization / Recording

System initializes within 30 seconds when power is on. PWR green light ON when system is rebooting. System starts to recording when REC green light is flashing.

■ Shut off/ Stop recording

Device offer prolonged 3 seconds recording after power off to ensure data is well stored; user can take out the SD card when indication is off.

Installation of SD card

- (1). Counterclockwise to unscrew the screw of dustproof lid to install/ takeoff the SD card.
- (2). Please do SD card format/ restoration with attached player.

! Attention

- (1). Suggest to use class 10, 8GB above.
- (2). Before using the memory disk, please format the disk first by using the software player in the CD-ROM. If not, device will automatically erase all data in the memory disk before recording.
- (3). To ensure recording quality, please do not use adapter card with Micro SD card. Doing so may lead to bad connection due to shock and vibration.
- (4). All memory disks have limited lifespan. Please regularly watch videos on PC and check the memory disk to ensure proper functioning.
- (5). Collision and vibration may cause SD card defective and result intermittent recording, please check data and backup file periodically.

DVR installation diagram

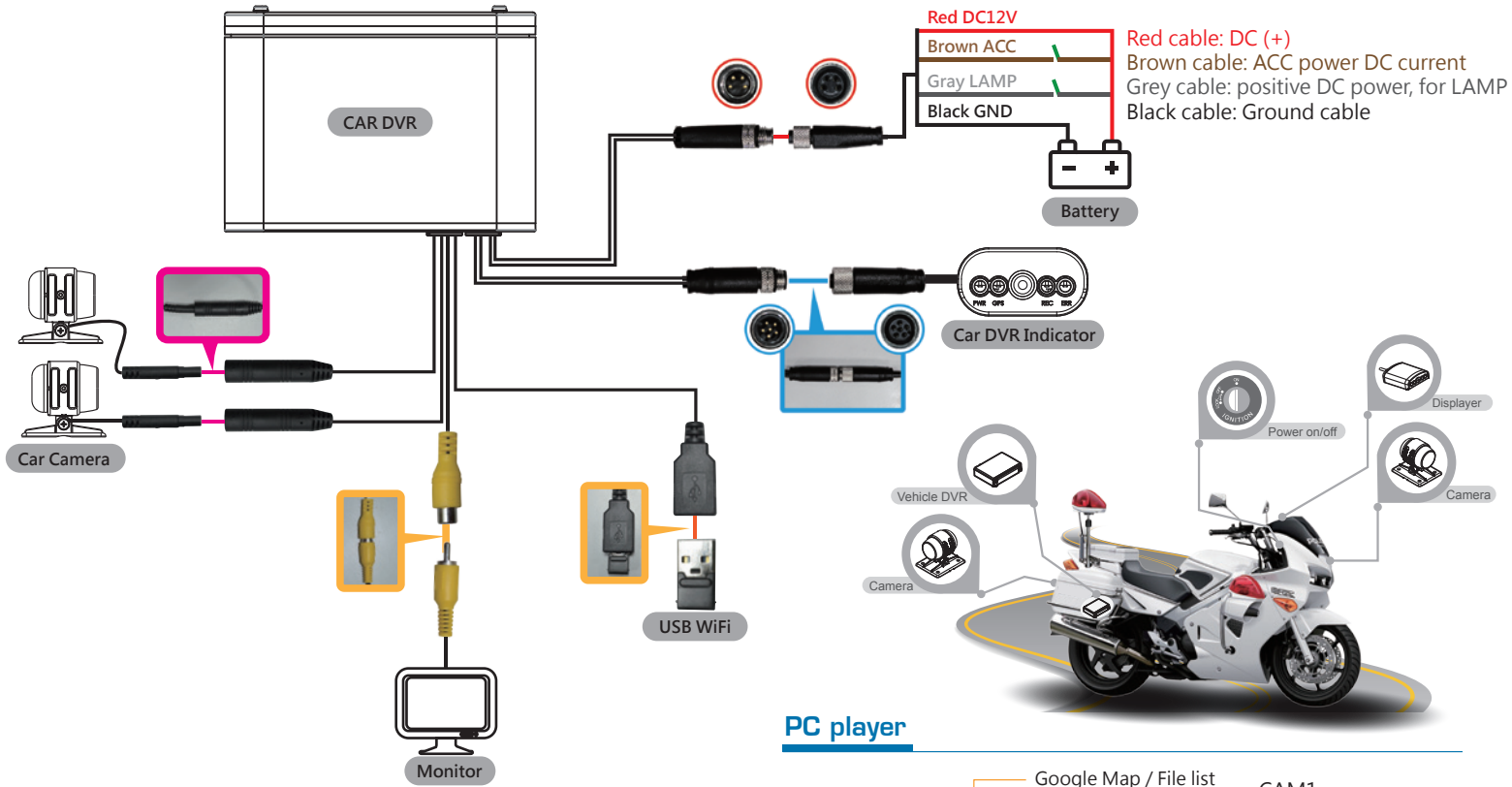

PC player

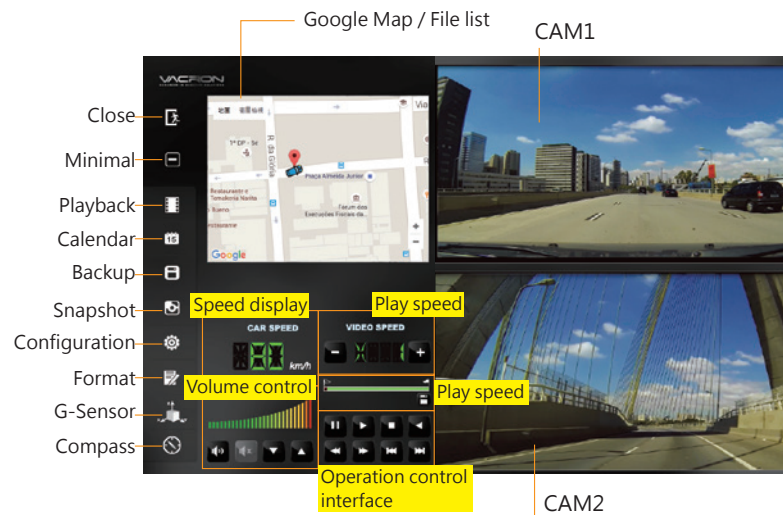

Explanation

- Please install device by professional installation engineer; temporary installation is suggest to fixed with tape included; please take high attention from damaging motor oil and power supply.
- Please keep device cabling from gasoline tube and oil tank; please install DVR when engine is off.
- Please don't use micro-SD adaptor as recording device, it may cause intermittent recording and unstable connect from driving vibration.
- Please use tape to seal connector well after cabling in order to prevent cabling loosens and dirt, oil, water from entering.
- All cabling should be installed with fuse protection.
- DVR should be fixed well to prevent moving and causes device from damages.
- GPS positioning precision is interfered by installation position and weather condition.

Attention

- Camera video and signal may be electromagnetic interfered of installing on non-EMC certified vehicles.
- Please use alcohol to clean cable connectors to eliminate dust, mud, oil, ...etc. to ensure signal transmission and video quality.
- NTSC or PAL frequency should be set according to local TV system.
- The machine consumes micro electric current when standby. If the vehicle wouldn't be used for long time, please remove DVR power to prevent power consumption to car battery. User needs to do time calibration after reconnect the DVR to car battery.
- Boot screen and OSD interface is subject to change according to software update or revision change without notice.
- Please remove the card and set to lock-state to avoid being overwritten for important event or accident records.
- Please shut off power before installing or removing cameras to protect from electric surge or short.
- DVR shuts off when ACC power is off, and DVR time setting is rely on car battery.

WiFi Connection



APP Player

Attention

- There might be video transmission delay due to wireless transmission.
- Remote playback video file only available for SD card record without overwriting
- Please remember to restore WiFi setting to external network after using Vacron Player.
- It is recommended to check regularly with the use of the Laptop player to play the video. Make sure the video system maintain normal operations if OBD is not installed.

- Visit Google Play store and search for " VacronPlayer " and download.
- Turn on WLAN name 「 SSID 」 · password 「 12345678 」 ·
- Run APP " VacronPlayer " , click " Device list " then " Add " , key in a preferred device name.
- Click on device name and choose " All Channel " to see LIVE VIEW
- Function: Live view image shot, Live recording, Video playback, Video backup.