

720P / 960H

Waterproof Vehicle Camera



AVM-H237B(720P)
AVM-H237A(960H)

NEW 2017 JUL. V1.0



- 1/4" CMOS Sensor
- 2.0mm Lens
- Suitable for trucks and buses monitoring
- Waterproof IP68, suitable to install at any places
- Video adjustable for mirroring if in need (Optional)

720P/960H Waterproof Vehicle Camera

AVM-H237B / AVM-H237A

Dimension Unit : mm

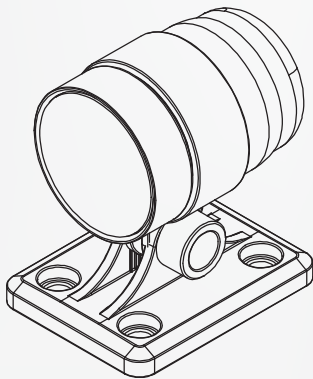
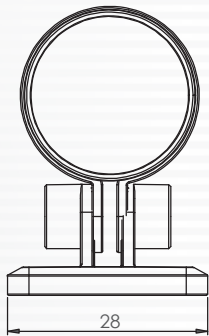
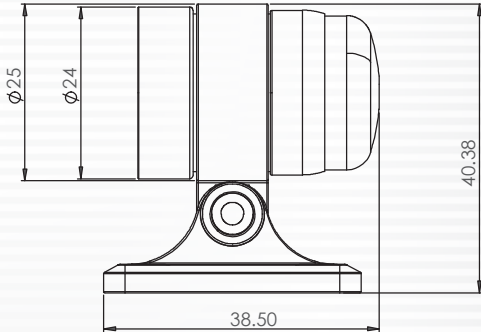

SPECIFICATIONS

| | | |
|------------------------|---|-----------------------------|
| Model No. | AVM-H237B | AVM-H237A |
| Video System | NTSC \ PAL | |
| Pick Up | 1/4" CMOS Image Sensor | |
| Image Signal Process | Digital Signal Processing System | |
| Lens | 2.0mm LENS | |
| Number Of Pixel | 1280X720 | 960X480 |
| Effective Pixels | Approximately 1.0 Mega Pixel | Approximately 460,000 Pixel |
| Resolution | 720P | 960H |
| Power Supply | DC 12 ± 1V | |
| Power Consumption | 80mA | |
| Scanning System | Progressive Scan | |
| Sensitivity | 0.1 lux(4300mV/Lux-sec) | |
| S/N Ratio | Max 37 dB | |
| Auto Gain Contro | Auto | |
| Mirroring | Optional (AVM-H237B-BV) | Optional (AVM-H237A-BV) |
| White Balance | Auto | |
| Electronic Shutter | NTSC: Auto: 1/60s to 1/100,000s PAL: Auto: 1/50s to 1/100,000s | |
| Output | 1 Vp-p Composite Video Output, 75 Ohms | |
| View Angle | 110° | |
| Operating Temperature | - 10° C ~ +60°C | |
| Dimensions (H × W × D) | 40.38 × 28 × 38.5mm | |
| Weight | About 150 g | |
| Waterproof | IP68 | |

★Version updating is not going to inform, please check the on-going updating information

Vehicle Camera Installed instructions

