

VVN-CBE65A

User Manual

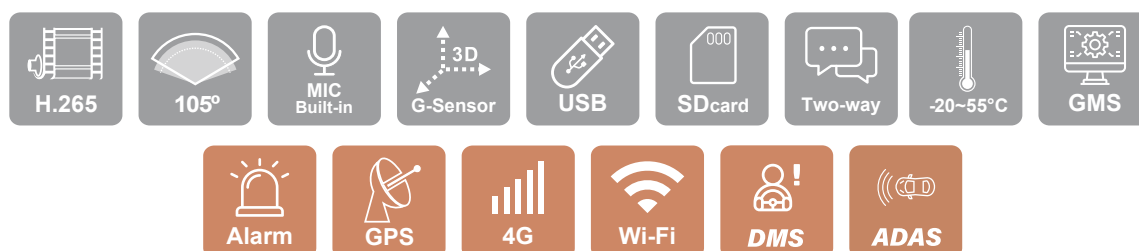

2024 SEP V1.0



(選配)

CAUTION

Dear User:

The prompt and accurate services will be carried by the dealer. We will reserve the right to make any software or hardware modification and physical improvements to this series of products without making prior notice.

Please read the manual carefully before using this product:

System Installation Precaution

- Please learn the electric wiring of the device before installation.
- Please select storage devices that are recommended by the dealer and meet the demands for the device to operate, to accomplish long-term IOPS needs with large amounts of data. Meanwhile, please purchase from certificated access to ensure the quality of the storage device.
- If you have any questions or require assistance, please get in touch with the Technician from the authorized dealer.

In-Vehicle system precaution

- Do not let any liquid or foreign material enter, drop or soak into the machine.
- Do not detach, repair or replace any components on one's own.
- If you encounter any malfunction, please contact the dealer or manufacturer, and we will provide solutions to cope within the smallest amount of time possible.

Operating Environment

- Please place or use this device under the operating temperature and avoid direct sunlight or being near heat.
 - Do not place the device in humid or moist environment.
 - Do not expose the device to smoking or dusty environment.
 - Avoid strong collision and drop.
 - Please install the device in a well-ventilated place and avoid any block to the vent.
 - Please operate the device under the rated range of current and Voltage input and output.
 - The device is a mechanization device design for long term use, do not place it near flammable or explosive items.
-

Menu

Operation precautions

A. Product Accessories	1
B. Features	1
C. Specifications	2
D. Appearance	3
E. Installation Guideline	4
F. Memory Card Precaution	5
G. WIFI connection (from APP)	6

A. Product Accessories

Please check the containing items for the following accessories before use.

Please contact the retailer if the containing items.

- **This product contains the following accessories**

1. Dash Camera*1
2. Mounting bracket
3. Windshield socket x1 and 3M double-sided tape *1

- **Optional**

1. Vacron SmartInfo Micro SD card
2. USB WiFi

B. Features

1. M.I.T Novatek Soc, Durable, Reliable and clear image solution
2. Build-in front/rear-facing FHD cameras, and support extra 1ch FHD Vacron camera, able to record both interior and exterior conditions
3. Build-in the speaker & microphone to enable audio recording and IP voice communication.
4. Support programable setting on ACC-Off recording for parking surveillance application.
5. Equipped with an ADAS camera, it can help the driver stay aware of the road in front and send an alarm to remind the driver when there is a too-narrow distance from the front vehicle or rough traffic conditions ahead.
6. Equipped with a DSM camera, it can detect whether the driver is performing fatigued or distracted driving behavior and alert to lower the chances of a serious accident.

C. Specifications

• Dash camera specifications

System SOC	Novatek
Lens	(1) Build-in Road-facing camera, up to 1080P/30fps, FOV(D/H/V): 119°/107°/54° (2) Build-in Road-facing camera, up to 1080P/15fps, FOV(D/H/V): 134°/123°/61° Support external Vacron 3 ch camera, 1080P/30fps and 5V power supply (optional)
Recording	1. Support H.265 and 1080P/720P/480P resolution on Road-facing, Cabin-facing and external 3Ch cameras 2. Supports manual-activate Event recording, lock. 3. Support G-Sensor triggered event recording, file lock, and auto-upload function. 4. Support ACC-OFF post-recording with software programmable timing. 5. Support parking monitoring mode: vibration/movement triggered event recording
I/O Ports	Micro SD Card Slotx1, mini-PCle socketx1, Standard SIM Card Slotx1+ USBx1
I/O Wire	1. Power set *1 (Battery+Ground+ACC) 2. External 3ch camera-in(blue micro-DIN) *1
Illumination	850m IR LED *4 for illumination of interior recording, Light sensor *1
WiFi	Support mobile phone P2P connection and Wi-Fi Internet connection
Environment	1. Operating temperature: -20°C~+55°C, Storage temperature: -40°C~+85°C 2. Operating humidity: 20%~80%, Storage humidity: 10%~90%
Power Supply	DC 9-36V
Dimensions	127mm x 76.5mm x 35mm(LxWxH)
Weight	250g

• Optional

Storage Device	Vacron SmartInfo Micro SD Card (Optional) Compatible with SDXC, Class 10 or above; minimum support 8GB; maximum support 512GB
Lens	Support external Vacron 3 ch camera, 1080P/30fps and 5V power supply (optional)
I/O Wire	SMARF external cable: 4G x1 + GPS/GNSS *1 (optional)
WiFi	USB WiFi4 module with antenna (optional)

Note: Subject to change without notice.

D. Appearance

Device



Front



Rear



Lateral

E. Installation Guideline

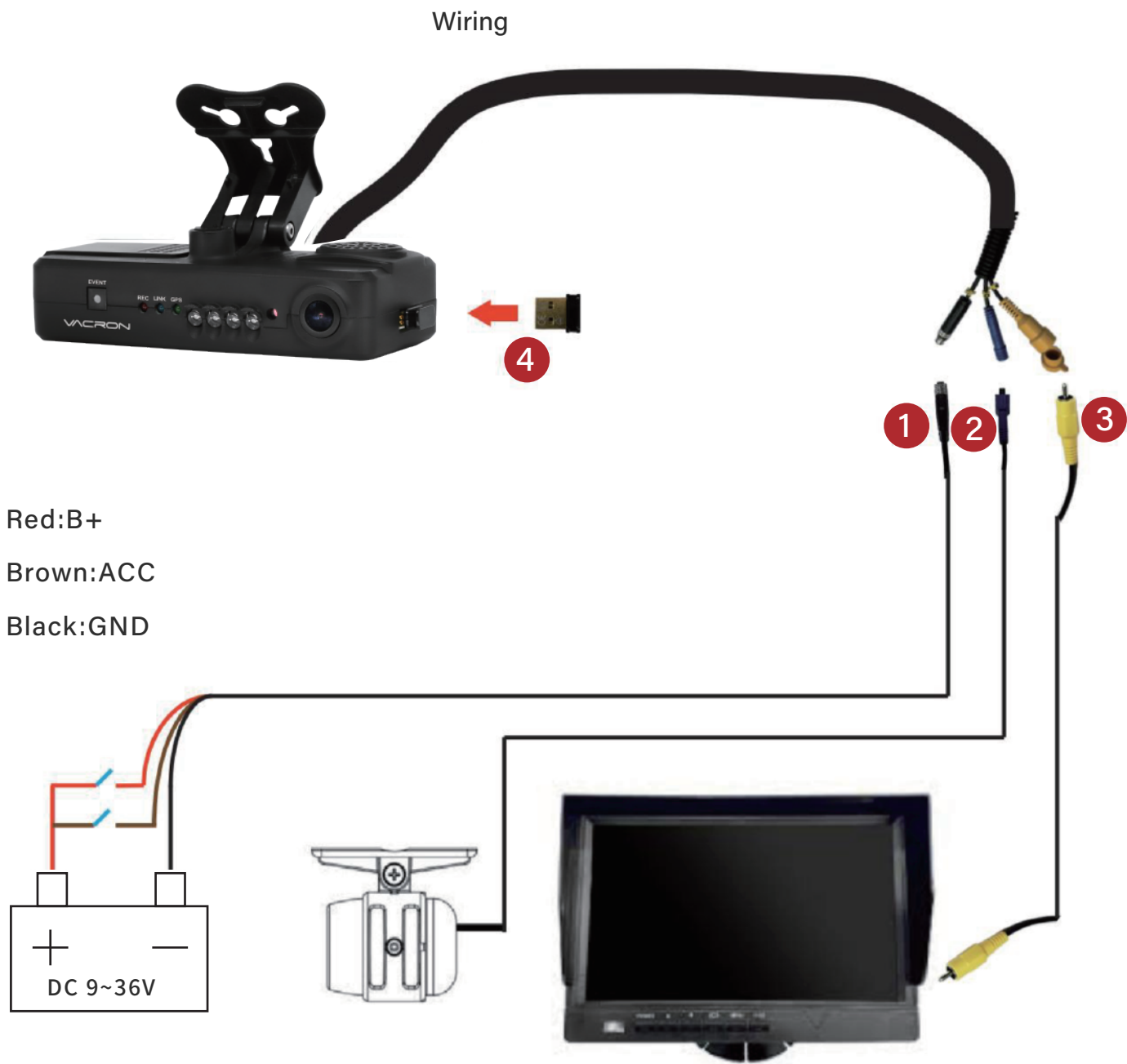

- 1 Power lead
- 2 External Camera
- 3 Image signal output terminal
- 4 WiFi USB Dongle

F. Memory Card Precaution



CAUTION

- (1) It is recommended to format the device with the APP before use, otherwise, the device will erase all data in the memory disk before recording with the default setting.
- (2) There is a life span issue within the memory card, please check the memory card and play it on the App regularly, along with formatting the memory card to ensure it is still functioning.
- (3) Collision or high vibration may cause physical damage to the memory card and lead to stammering records or inability to play, please check and keep a backup for important data.

G. WIFI connection (from APP)

(a) Download vis QR Code:

VACRON LINK iOS



VACRON LINK Android



(b) App operation:

- 1. Search "VACRON LINK" on APP store for downloading.
- 2. Open WiFi on the smartphone and connect to SSID-XXXXXX.
Enter the default password 12345678.

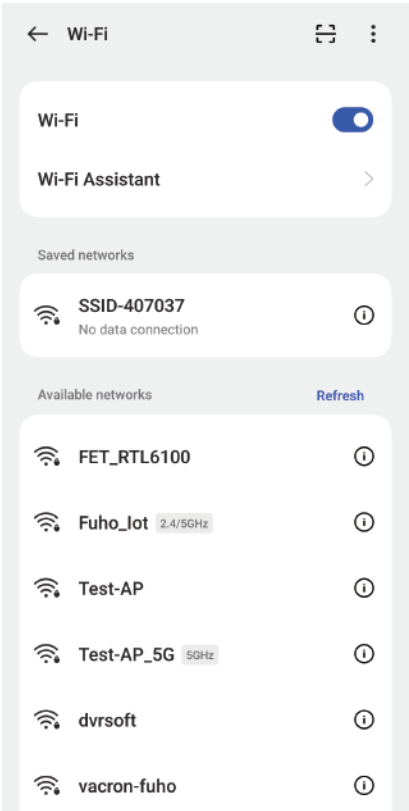

3. Open "VACRON LINK", and click the "WiFi connection" in the main interface.



The image of the device will be shown after entering.
Click the red frame to start settings.

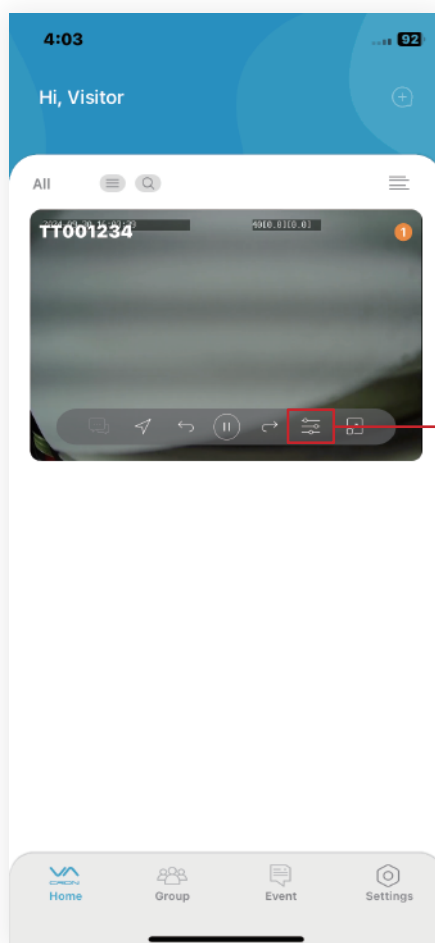

4. App main interface

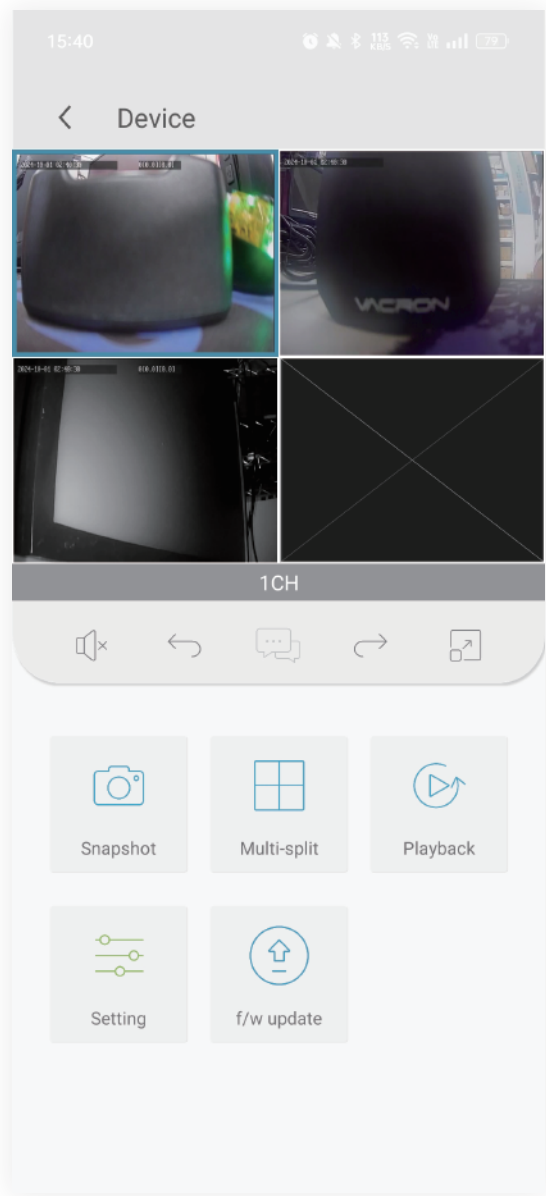

Snapshot / Multi-split / Playback /
Settings / Firmware update

5. Playback

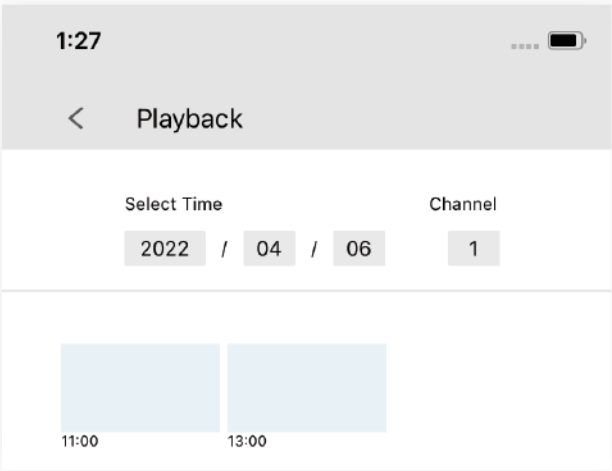

Select the playback time stamp after clicking Playback to play the video.

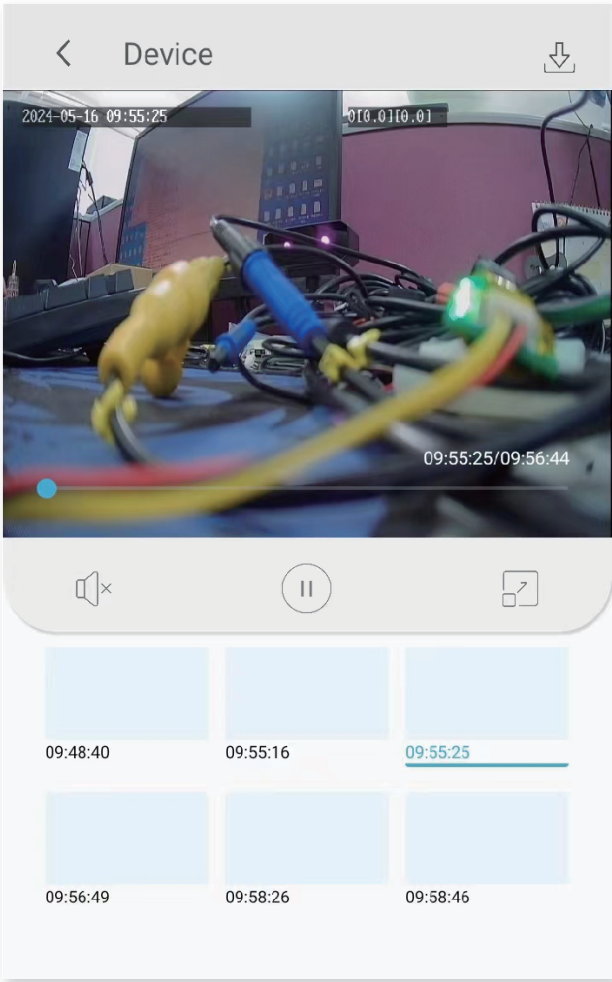

6. App Settings interface

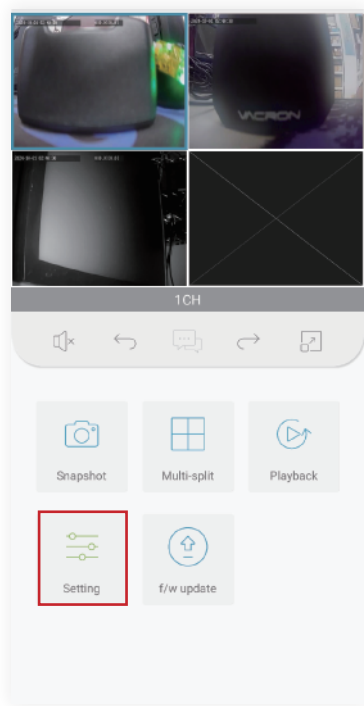

Click to enter.

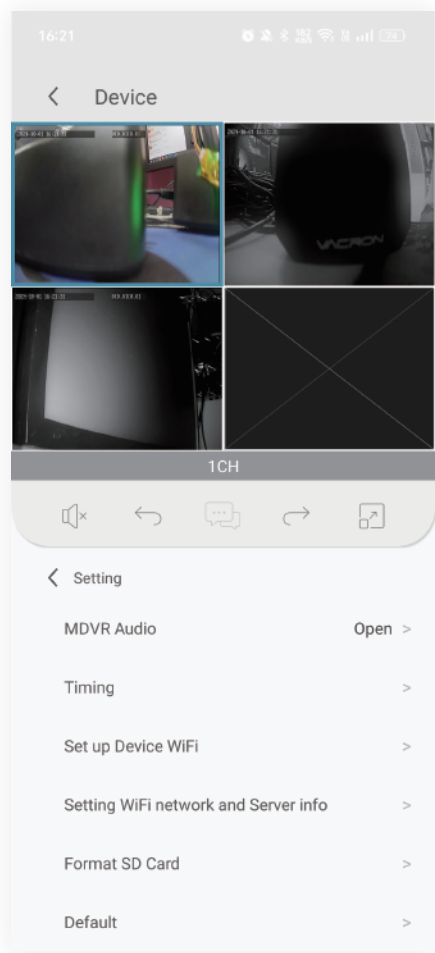

Wi-Fi settings / Device information / Versions
Memory card health status / Audio settings / Time correction
Wi-Fi settings / Server Configuration / Memory card format
FPS / Code Rate / GPS OSD display / Default

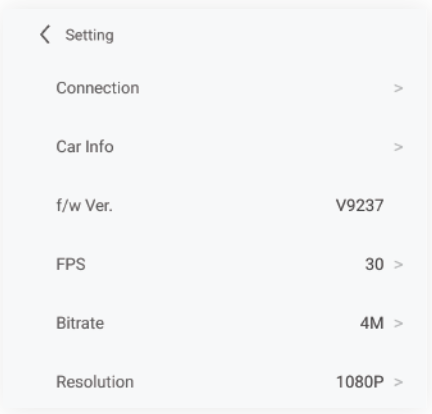

7. FPS Settings



Setting Range 1-30

8. Bitrate Settings



Could select from 512k, 1M, 2M, 3M, 4M, and 5M.
Click "Save" to save settings.

9. Resolution Settings



Supports 720P and 1080P

10. GPS OSD

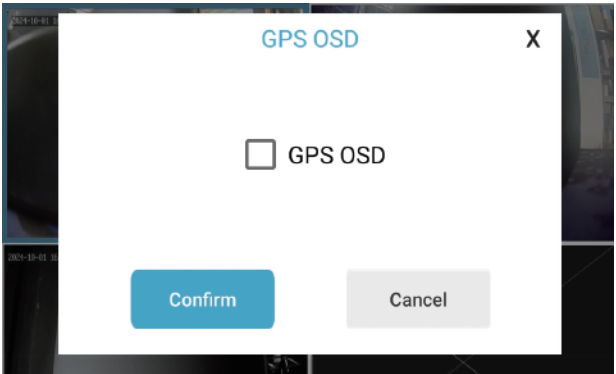

11. Audio settings via App

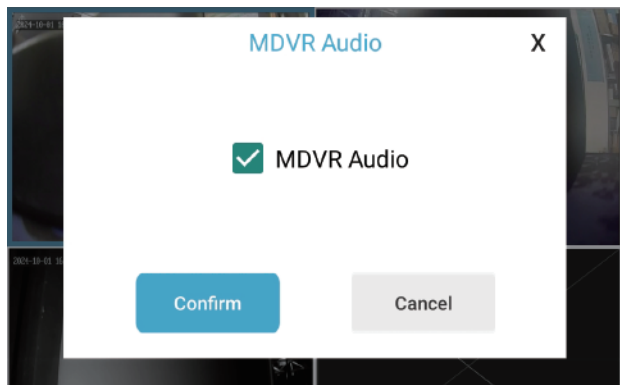

The device will start recieving voal when the audio setting is turned on, and stop when turned off.

12. Time Correction

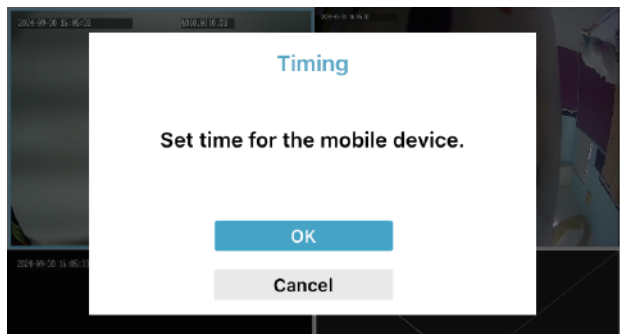

Network Time Protocol
The time will be corrected when the internet is connected.

13. Change the Wi-Fi name and password.



The name is preset as SSID-XXXX.
The name and password could be changed in this section.

The App will withdraw and reconnect after the setting.
New Wi-Fi name and password could be applied then.

14. Format the memory card

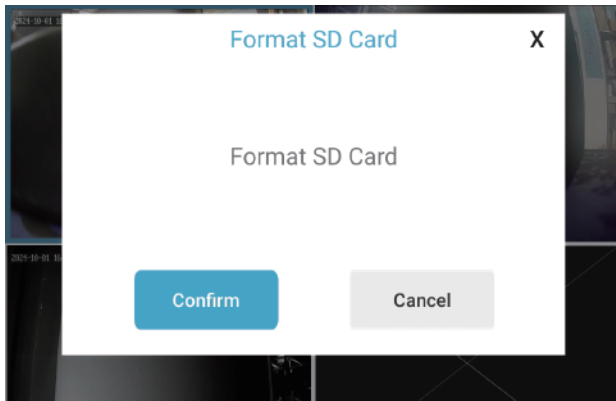

Click "Confirm" "to delete all datas.

15. Default Settings

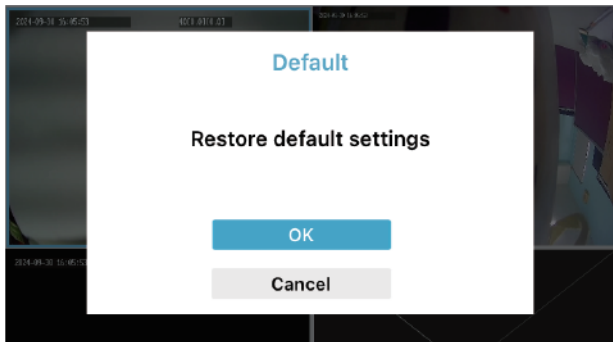

Click "Confirm" "to restore default settings.



CAUTION

- (1) Live streaming may lag due to wireless transmitting and receiving.
- (2) The remote operation function is limited to only the data in the storage device. If the data on the SD card has been overwritten, the data for that period cannot be searched.
- (3) When the operation is over, please remember to close the Wi-Fi connection with the machine; otherwise, the phone will not connect to the external network.
- (4) If there is no led display indicator, it is recommended to regularly check and use a computer to play images to ensure the regular operation of the recording system.



<https://www.vacron.com.tw>

Made in Taiwan
